

Cinema Build Systems Halo Frame System Overview



What is Halo Frame?

Halo Frame is a modular and scalable frame system for creating fabric wall panelling for a wide range of applications.

Advantages?

Halo Frame is lightweight, simple to specify, easy to install, customisable and available on short lead times. The only specialist tools required are the fabric insertion tools we sell.

What does it solve?

Halo Frame reduces the complexity of panel builds and reduces the time required for the installation process.

How does it arrive?

Halo Frames are manufactured to the size specified, complete with all cutting and fabrication. They are shipped packaged flat packed, ready for assembly and installation.

How is it installed?

Halo Frames are assembled using the supplied corner connection brackets with the Allen key supplied. The built frame is then mounted to the wall using suitable fixings (not supplied) and attached to the supplied wall brackets. Once this stage is complete, either acoustic control products or LED lighting can be added. Finally the fabric is stretched into the retaining track, trimmed to size then tucked and tensioned.

Cinema Build Systems Halo Frame System Overview



Halo Frame System RETAIL Price List - Valid from January 2022

HF-S-SERIES (Frame and brackets only)	Description	Qty	RETAIL Ex VAT	RETAIL inc VAT
---------------------------------------	-------------	-----	------------------	-------------------

Modular Systems for creating wall panels.

Wall mount options: Flush (60mm total), Deep (100-120mm total), Louvred (60- 120mm angle)- Lead Time: (1- 2 Weeks)

HF-750-750-S-X	750mm x 750mm Halo Frame in silver anodised finish	Each	£200.00	£240.00
HF-750-1500-S-X	750mm x 1500mm Halo Frame in silver anodised finish	Each	£300.00	£360.00
HF-750-2250-S-X	750mm x 2250mm Halo Frame in silver anodised finish	Each	£400.00	£480.00
HF-1500-1500-S-X	1500mm x 1500mm Halo Frame in silver anodised finish	Each	£400.00	£480.00
HF-1500-2250-S-X	1500mm x 2250mm Halo Frame in silver anodised finish	Each	£500.00	£600.00

HF-S-SERIES KIT (Including Soft Slab 43 Foam Absorbers and Camira Blazer Lite Acoustically Transparent Fabric)	Description	Qty	RETAIL Ex VAT	RETAIL inc VAT
--	-------------	-----	------------------	-------------------

Modular Systems for creating wall panels.

Wall mount options: Flush (60mm total), Deep (100-120mm total), Angled (60- 120mm angle)- Lead Time: (1- 2 Weeks- Although fabric availability may affect lead time)

HF-750-750-S-X-KIT	Includes 1x Soft Slab 43 Absorbers and 1m x 0.8m of Camira Blazer Lite	Each	£250.00	£300.00
HF-750-1500-S-X-KIT	Includes 2x Soft Slab 43 Absorbers and 1m x 1.7m of Camira Blazer Lite	Each	£395.83	£475.00
HF-750-2250-S-X-KIT	Includes 3x Soft Slab 43 Absorbers and 3m x 0.8m of Camira Blazer Lite	Each	£541.67	£650.00
HF-1500-1500-S-X-KIT	Includes 4x Soft Slab 43 Absorbers and 2m x 1.7m of Camira Blazer Lite	Each	£583.33	£700.00
HF-1500-2250-S-X-KIT	Includes 6x Soft Slab 43 Absorbers and 2.5m x 1.7m of Camira Blazer Lite	Each	£750.00	£900.00

Frame Order Codes:

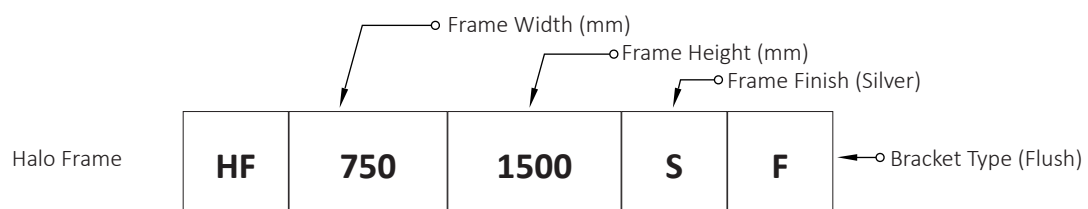

Halo Frame System RETAIL Price List - Valid from January 2022

HF-CUSTOM-SERIES

Custom Sized Halo Frames - Modular Systems for creating wall panels.

Wall mount options: Flush (60mm total), Deep (100-120mm total), Angled (60 - 120mm angle) - Lead Time: (2 - 3 Weeks)

How to calculate a Custom frame cost.

The cost of a Halo Frame is based on its perimeter. So for example a 1m wide, by 2m high frame would have a perimeter of 6m (this is calculated by adding the width (1m) to the height (2m) = (3m) and the doubling it (3m x 2) = (6m)

We double it as we have a top + bottom (2x Width) and 2 vertical sides (2x Height)

Then to calculate the cost, we multiply the perimeter by the linear cost. For example at SRP (Inc Vat) on silver anodised - 6m perimeter x £80 per m cost + (6 x 40) = £480 inc Vat.

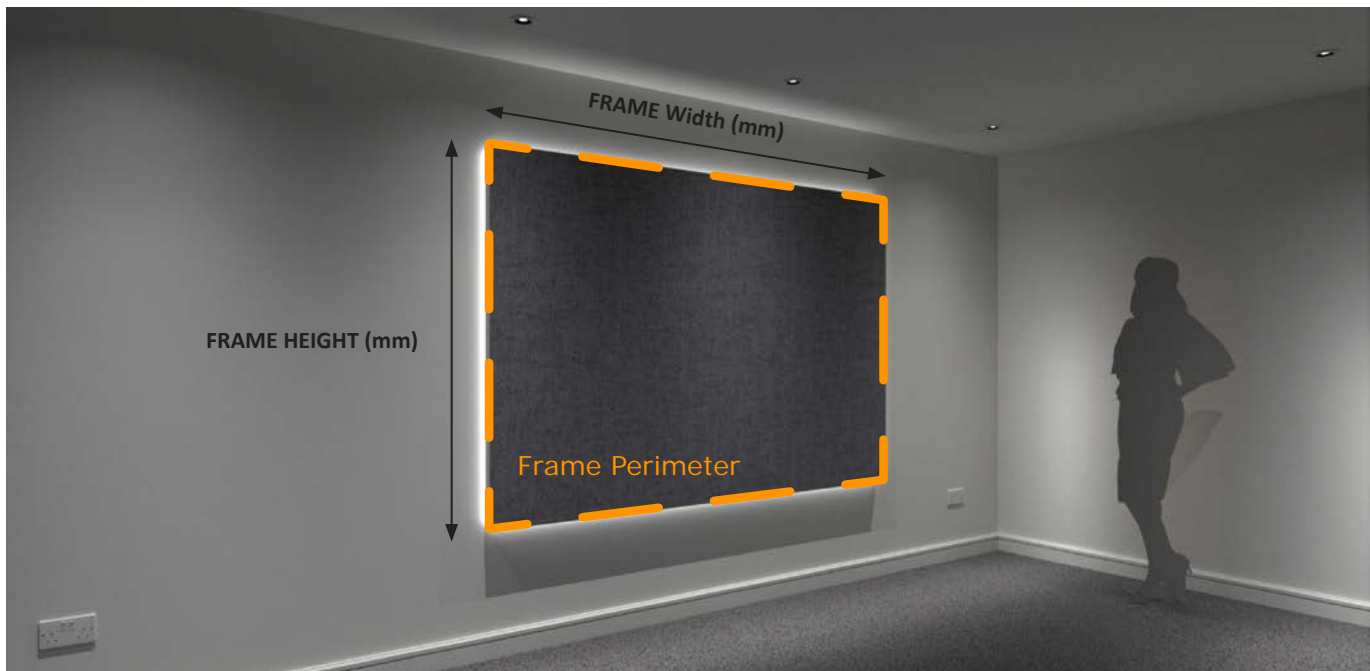

Frame Order Codes:

		○ Frame Width (mm)	○ Frame Height (mm)	○ Frame Finish (Silver)	
Halo Frame	HF	750	1500	S	F
					○ Bracket Type (Flush)

Halo Frame System RETAIL Price List - Valid from January 2022

HF-CUSTOM-SILVER

Custom Sized Halo Frames - We are able to manufacture Halo Frames to Custom sizes as requested. The flexibility custom sizing brings is endless. Media Walls, Speaker Columns, Floating Panels and Louvre Wall arrangements can all be easily achieved using custom sized frames.

Modular Systems for creating wall panels.

Wall mount options: Flush (60mm total), Deep (100-120mm total), Angled (60 - 120mm angle) - Lead Time: (2 - 3 Weeks)

Halo Frame Panels	Description	Qty	RETAIL Ex VAT	RETAIL inc VAT
HF-CUSTOM-S	Perimeter Cost (double width + double height) per m (Silver Anodised)	Each	£66.67	£80.00

HF-CUSTOM-RAL

Custom RAL Powder-coated Halo Frames.

In addition to custom sizing Halo Frames, we can also colour match them to requirements. We are able to colour match fabrics using a NIX colour sensor and then Powdercoat the Halo Frames in the corresponding colour - Lead Time: 3 - 5 Weeks

Halo Frame Panels	Description	Qty	RETAIL Ex VAT	RETAIL inc VAT
HF-CUSTOM-RAL	Perimeter Cost (double width + double height) per m (Powder Coated RAL Finish)	Each	£83.33	£100.00

Frame Order Codes:

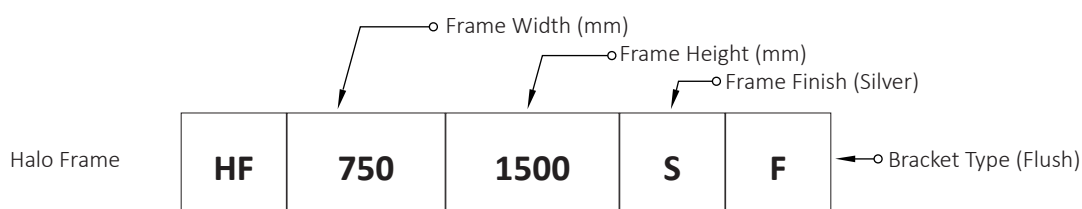

Halo Frame System RETAIL Price List - Valid from January 2022

HF-CUSTOM-SERIES

Mounting Options

The mounting options available for Halo Frame are very flexible and included in the frame cost.

Flush Brackets. (F)

As standard the frame will come with flush mount brackets.

These fix the frame either flush to the wall (Total Depth 60mm) or up to 20mm off the wall (Total depth 80mm) due to adjustable slots on the mount.

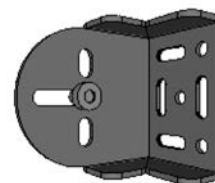

Deep Brackets. (D)

These fix the frame either 40mm off the wall (Total depth 100mm) or up to 60mm off the wall (Total depth 120mm) due to adjustable slots on the mount.

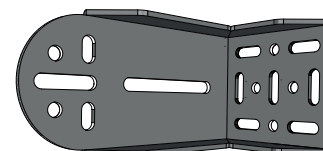

Flush / Deep Louvre Combination Brackets. (L)

To create an overlapping / Louvre style wall effect with Halo Frames. These fix the frame either flush to the wall (Total Depth 60mm) or up to 20mm off the wall (Total depth 80mm) due to adjustable slots on the mount.

Hanging Flush Brackets. (H)

Another option, where panels need to be removed are hanging flush mount brackets.

These require approximately 30mm of space above the frame to drop it in place, but very handy where access is required.

These fix the frame flush to the wall (Total Depth 60mm)

Frame Order Codes:

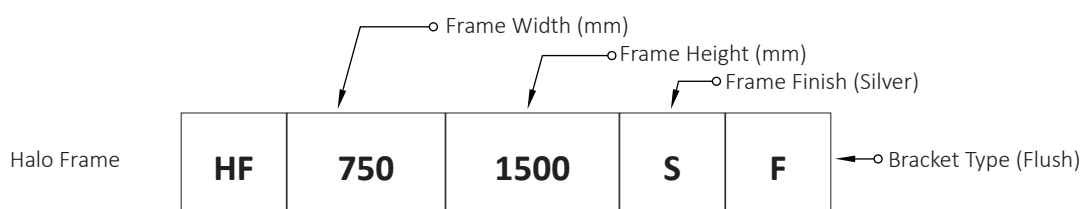

Halo Frame System RETAIL Price List - Valid from January 2022

Halo Frame Profile Diagram

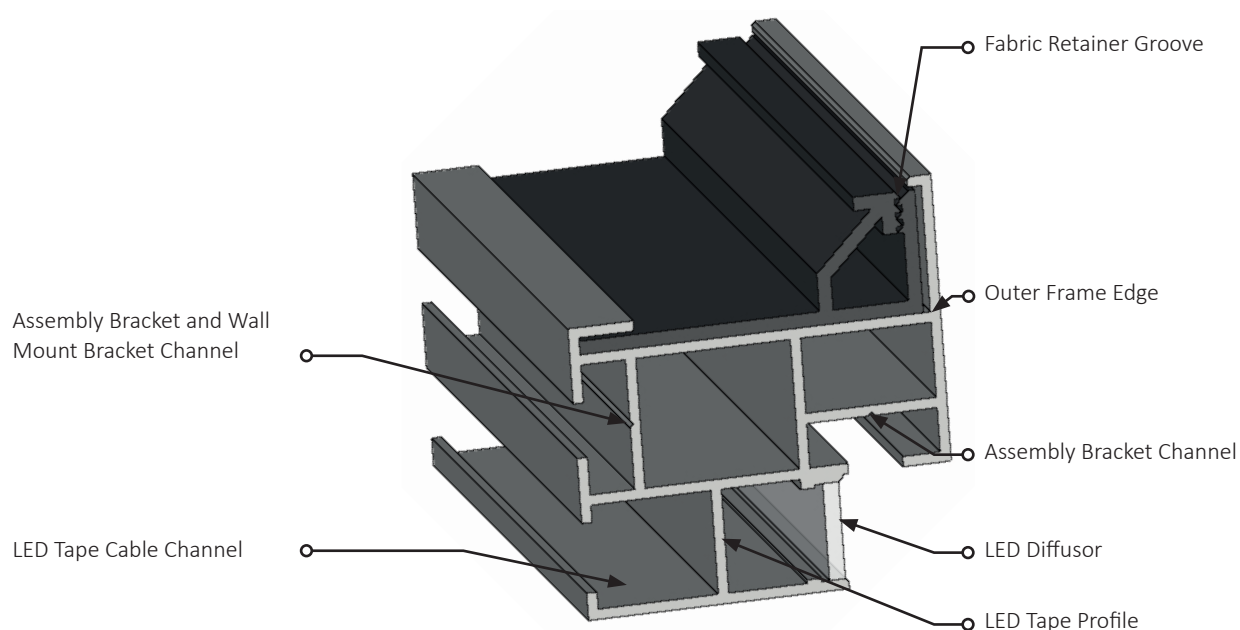

Halo Frame Profile Dimensions

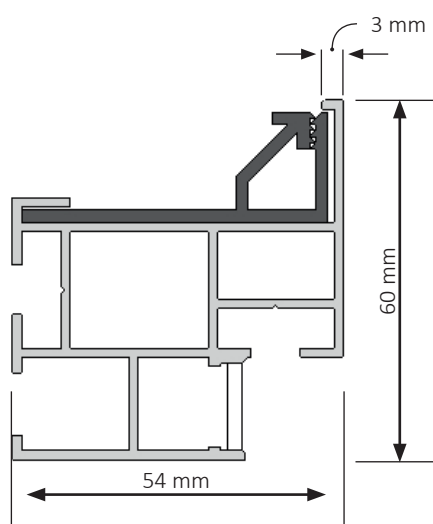

Halo Frame Flush Wall Mount

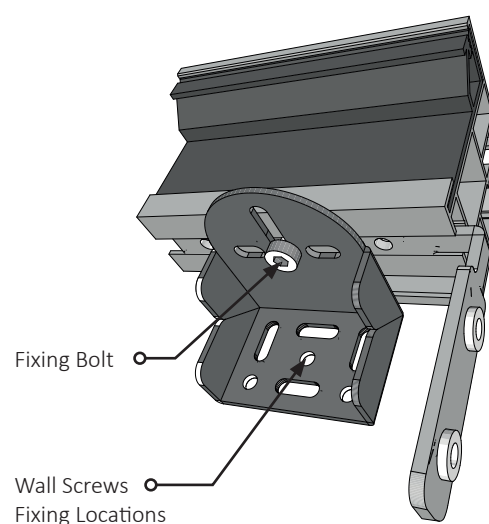

Halo Frame System RETAIL Price List - Valid from January 2022

EXAMPLE LAYOUTS

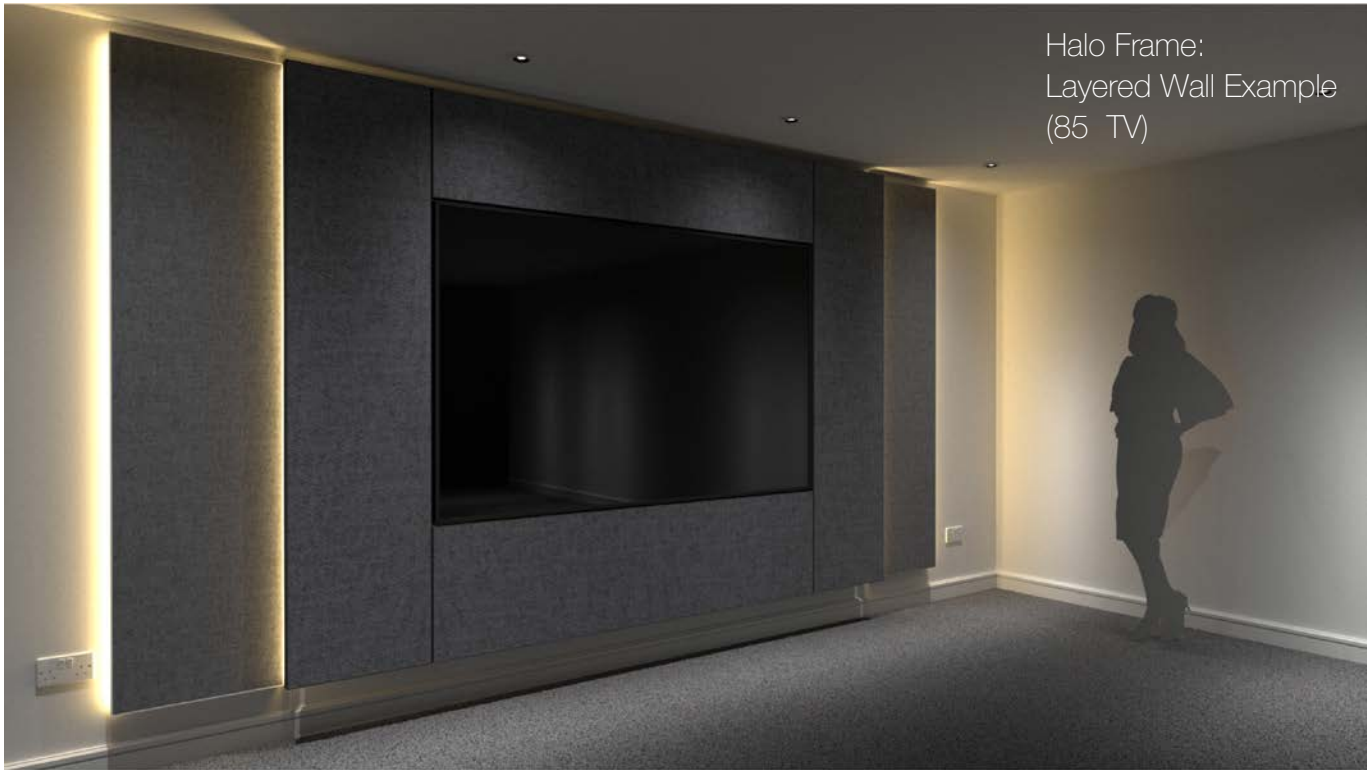

Halo Frame:
Layered Wall Example
(85" TV)

Halo Frame - Layered Media Wall Example (85" TV).

Example wall based on an 85" Flat Panel Display, mounted on an Articulated Pull out bracket. Pricing below is for the Halo Frame sections required. Fabric, Acoustic treatment and Lighting is not included in the pricing below. Pricing for guidance only.

Halo Frame Panels	Description	Qty	RETAIL Ex VAT	RETAIL inc VAT
HF-500-2100-S-F	500mm x 2100mm Halo Frame in silver anodised finish (Flush)	2	£693.33	£832.00
HF-500-2100-S-D	500mm x 2100mm Halo Frame in silver anodised finish (Deep)	2	£693.33	£832.00
HF-1916-400-S-D	1916mm x 400mm Halo Frame in silver anodised finish (Deep)	1	£308.80	£370.56
HF-1916-493-S-X	1916mm x 493mm Halo Frame in silver anodised finish (Deep)	1	£321.20	£385.44
Totals			£2016.67	£2420.00

Halo Frame System RETAIL Price List - Valid from January 2022

EXAMPLE LAYOUTS

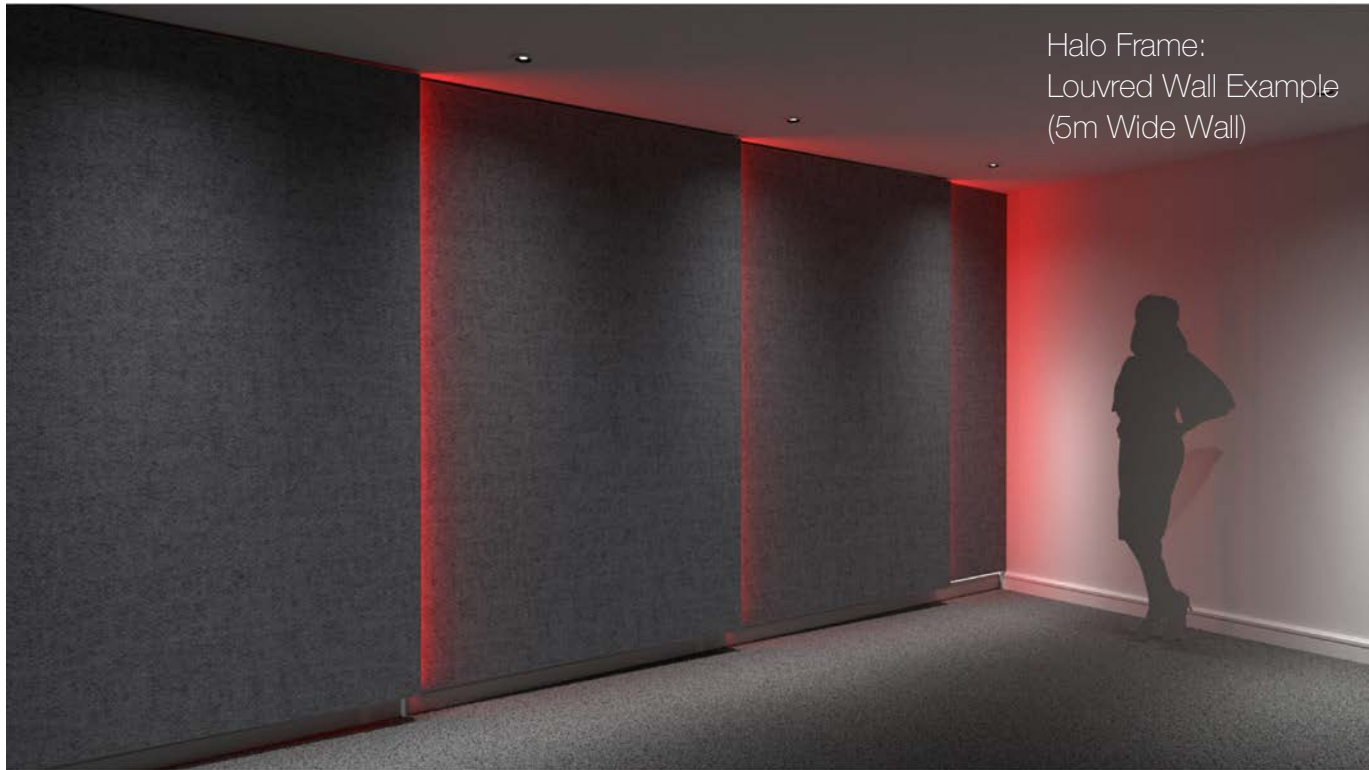

Halo Frame - Louvred Side Wall Example (5m Wide Wall)

Example single wall based on an 5000mm Long wall, covered with 3x 1500mm and 1x 750mm Wide Halo Frames in a Louvre Style Arrangement. Pricing below is for the Halo Frame sections required. Fabric, Acoustic treatment and Lighting is not included in the pricing below. Pricing for guidance only.

Halo Frame Panels	Description	Qty	RETAIL Ex VAT	RETAIL inc VAT
HF-1500-2250-S-X	1500mm x 2250mm Halo Frame in silver anodised finish	3	£1500.00	£1800.00
HF-750-2250-S-X	750mm x 2250mm Halo Frame in silver anodised finish	1	£400.00	£480.00
Totals			£1900.00	£2280.00

Halo Frame System RETAIL Price List - Valid from January 2022

FABRIC TOOLS

Specialist Fabric Walling Tools, for use installing stretch fabric walls and ceilings.

Fabric Track Profiles	Description	Qty	NETT Ex VAT	LIST EX VAT	LIST inc VAT
CSF-TOOL-DUAL-ROLLER	Dual Roller Fabric Insertion Tool With Offset Handle	Each	£80.00	N/A	N/A



Fabric Track Profiles	Description	Qty	NETT Ex VAT	LIST EX VAT	LIST inc VAT
CSF-TOOL-HATCHET	Hatchet Insertion Tool	Each	£45	N/A	N/A



Fabric Track Profiles	Description	Qty	NETT Ex VAT	LIST EX VAT	LIST inc VAT
CBS-TOOL-SPATULA	Basic Fabric Insertion Tool	Each	£30.00	N/A	N/A



Fabric Track Profiles	Description	Qty	NETT Ex VAT	LIST EX VAT	LIST inc VAT
CSF-TOOL-SCISSORS	Fabric Cutting Scissors	Each	£6.00	N/A	N/A

Fabric Track Profiles	Description	Qty	NETT Ex VAT	LIST EX VAT	LIST inc VAT
CSF-TOOL-LINT	Lint Roller	Each	£6.00	N/A	N/A